

Bearings

Technical details

Metric

Inch

Operating conditions

Maximum Speed 5.0 m/sec
Temperature Range -40°C + 120°C

15.0 ft/sec
-40°F + 250°F

Surface roughness

	µmRa	µmRt	µinCLA	µinRMS
Dynamic Sealing Face – Rod $\varnothing d_1$	0.4	4 max	16	18
Static Sealing Face – Rod $\varnothing D_2 L_1$	3.2 max	16 max	125 max	140 max
Dynamic Sealing Face – Piston $\varnothing d_1$	0.4	4 max	16	18
Static Sealing Face – Piston $\varnothing d_2 L_1$	3.2 max	16 max	125 max	140 max

Housing Details & Tolerances

L_1 in	+0.015	+0.010	
r_1 in	0.016	max	
Rod $\varnothing d_1$ in	f9		
$\varnothing D_2$ in	$\varnothing d_1 + 2S$	+0.004	-0.000
$\varnothing D_3$ in	$\varnothing d_1 + G$		
Piston $\varnothing D_1$ in	H11		
$\varnothing d_2$ in	$\varnothing D_1 - 2S$	+0.000	-0.004
$\varnothing d_3$ in	$\varnothing D_1 - G$		
1/8 nominal cross sections - in	$S = 0.126$	G max 0.080	G min 0.031
3/32 nominal cross sections - in	$S = 0.093$	G max 0.060	G min 0.031
1/16 nominal cross sections - in	$S = 0.063$	G max 0.040	G min 0.031

533

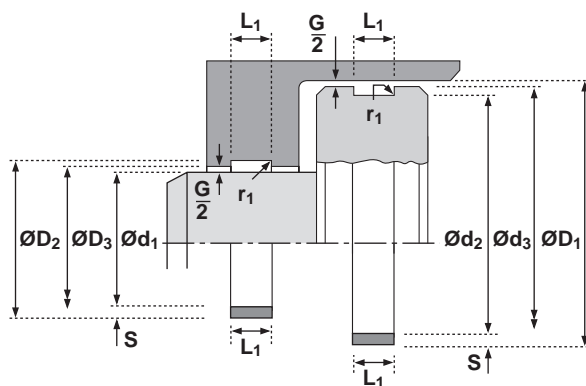

Design

Hallite 533 glass filled nylon wear rings are designed for reciprocating piston and rod bearing applications.

The standard material is heat stabilised 33% glass reinforced nylon 66 [Dynamic 533], which offers excellent bearing properties. The material is compatible with hydraulic and lubricating oils. The material is not recommended for use in water based fluids (HFA) or where significant water is present, due to the swell of the nylon. For these applications the use of Hallite 506 or Hallite 63 bearings are recommended.

Split Type

B indicates butt cut
S indicates scarf cut

Notes: Some sizes are rod specific only. Please contact your local Hallite Seals for the housing sizes for those parts marked * by the section S.

Other sizes and materials are also available upon request. For further information about these and any other sizes that you are looking for, please contact your local Hallite sales office.

Features

- Moulded to size
- Easy installation
- Robust
- Long life
- Economical

Material Options

9260171 lubricated GFN end part no with -171

533

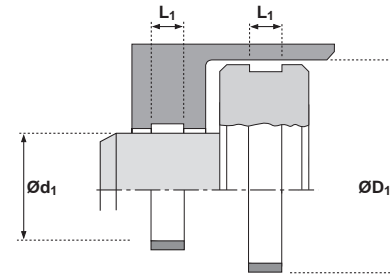

ØD ₁ in	Ød ₁ in	L ₁ in	S in	ØD ₁ mm	Ød ₁ mm	L ₁ mm	Rod Specific	Split Type	PART No
1.000	0.910	0.125	0.045 [†]	25.4	23.1	3.2		B	F30177
1.000	0.814	0.187	0.093	25.4	20.7	4.7		B	F30232
1.125	1.000	0.375	0.062	28.6	25.4	9.5		B	F30329
1.220	1.032	0.375	0.094 [†]	31.0	26.2	9.5		B	F30334
1.250	1.000	0.500	0.125	31.8	25.4	12.7		B	F30365
1.250	1.064	0.187	0.093	31.8	27.0	4.7		B	F30001
1.250	1.000	0.437	0.125	31.8	25.4	11.1		B	F30002
1.250	1.100	0.250	0.075 [†]	31.8	27.9	6.4		B	F30009
1.250	1.000	1.000	0.125	31.8	25.4	25.4		B	F30220
1.250	1.125	0.500	0.062	31.8	28.6	12.7	X	B	F30391
1.250	1.125	1.000	0.062	31.8	28.6	25.4		B	F30307
1.250	1.125	1.500	0.062	31.8	28.6	38.1		B	F30280
1.259	1.073	0.375	0.093	32.0	27.3	9.5		B	F30003
1.375	1.125	0.250	0.125	34.9	28.6	6.4		B	F30364
1.375	1.250	0.500	0.062	34.9	31.8	12.7		B	F30303
1.375	1.250	0.500	0.062	34.9	31.8	12.7	X	B	F30392
1.417	1.220	0.433	0.098 [†]	36.0	31.0	11.0		B	F30330
1.431	1.181	0.500	0.125	36.3	30.0	12.7		B	F30378
1.500	1.250	0.250	0.125	38.1	31.8	6.4		B	F30005
1.500	1.250	0.375	0.125	38.1	31.8	9.5		B	F30006
1.500	1.250	0.500	0.125	38.1	31.8	12.7		B	F30305
1.500	1.314	0.187	0.093	38.1	33.4	4.7		B	F30004
1.500	1.316	0.375	0.093	38.1	33.4	9.5		B	F30352
1.500	1.375	0.375	0.062	38.1	34.9	9.5		B	F30354
1.530	1.405	0.250	0.062	38.9	35.7	6.4		B	F20163
1.530	1.280	0.250	0.125	38.9	32.5	6.4		B	F30007
1.535	1.375	0.750	0.08 [†]	39.0	34.9	19.1		B	F30304
1.575	1.375	0.587	0.100 [†]	40.0	34.9	14.9		B	F30333

533

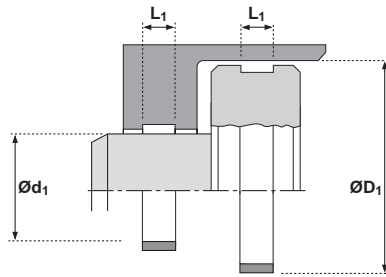

OD_1 in	od_1 in	L_1 in	S in	OD_1 mm	od_1 mm	L_1 mm	Rod Specific	Split Type	PART No
1.620	1.495	0.810	0.062	41.1	38.0	20.6		B	F30291
1.625	1.375	0.500	0.125	41.3	34.9	12.7		B	F30366
1.625	1.375	0.375	0.125	41.3	34.9	9.5		B	F30367
1.625	1.500	1.000	0.062	41.3	38.1	25.4	X	S	F10204
1.670	1.500	0.500	0.085 [†]	42.4	38.1	12.7		B	F30010
1.688	1.492	0.188	0.098 [†]	42.9	37.9	4.8		B	F30011
1.732	1.535	0.591	0.098 [†]	44.0	39.0	15.0		B	F30331
1.750	1.500	0.375	0.125	44.5	38.1	9.5		S	F20152
1.750	1.570	1.500	0.09 [†]	44.5	39.9	38.1	X	S	F10205
1.750	1.500	0.500	0.125	44.5	38.1	12.7		B	F30013
1.750	1.500	0.375	0.125	44.5	38.1	9.5		B	F30201
1.750	1.500	0.190	0.125	44.5	38.1	4.8		B	F30234
1.750	1.500	0.750	0.125	44.5	38.1	19.1		B	F30337
1.750	1.500	1.000	0.125	44.5	38.1	25.4		B	F30338
1.750	1.494	0.354	0.128 [†]	44.5	37.9	9.0		B	F30012
1.771	1.585	0.375	0.093	45.0	40.3	9.5		B	F30014
1.772	1.535	0.212	0.118 [†]	45.0	39.0	5.4		B	F30181
1.772	1.535	0.197	0.118 [†]	45.0	39.0	5.0		B	F30189
1.825	1.575	0.500	0.125	46.4	40.0	12.7		B	F30382
1.875	1.750	0.810	0.062	47.6	44.5	20.6	X	B	F30292
1.875	1.625	0.750	0.125	47.6	41.3	19.1		B	F30178
1.875	1.625	0.190	0.125	47.6	41.3	4.8		B	F30179
1.875	1.625	0.375	0.125	47.6	41.3	9.5		B	F30235
1.875	1.625	0.500	0.125	47.6	41.3	12.7		B	F30306
1.875	1.679	0.193	0.098 [†]	47.6	42.6	4.9		B	F30015
1.875	1.750	1.000	0.062	47.6	44.5	25.4	X	S	F10206
1.965	1.713	0.748	0.126 [†]	49.9	43.5	19.0		B	F30242
1.969	1.732	0.197	0.118 [†]	50.0	44.0	5.0		B	F30188

533

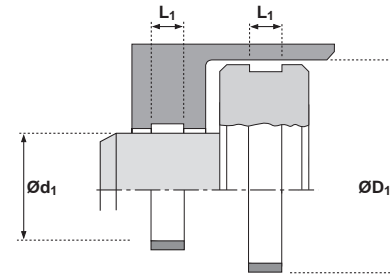

ØD ₁ in	Ød ₁ in	L ₁ in	S in	ØD ₁ mm	Ød ₁ mm	L ₁ mm	Rod Specific	Split Type	PART No
1.969	1.719	0.250	0.125	50.0	43.7	6.4		B	F30363
2.000	1.744	0.350	0.128 *	50.8	44.3	8.9		S	F20020
2.000	1.750	0.250	0.125	50.8	44.5	6.4		B	F30018
2.000	1.750	0.266	0.125	50.8	44.5	6.8		B	F30019
2.000	1.750	0.312	0.125	50.8	44.5	7.9		B	F30020
2.000	1.750	0.375	0.125	50.8	44.5	9.5		B	F30022
2.000	1.750	0.500	0.125	50.8	44.5	12.7		B	F30024
2.000	1.804	0.193	0.098 *	50.8	45.8	4.9		B	F30016
2.000	1.750	0.750	0.125	50.8	44.5	19.1		B	F30025
2.000	1.750	0.187	0.125	50.8	44.5	4.7		B	F40001
2.000	1.750	0.375	0.125	50.8	44.5	9.5		B	F40002
2.000	1.744	0.354	0.128 *	50.8	44.3	9.0		B	F30021
2.000	1.816	0.375	0.093	50.8	46.1	9.5		B	F30325
2.000	1.875	1.000	0.062	50.8	47.6	25.4	X	S	F10305
2.022	1.772	0.500	0.125	51.4	45.0	12.7		B	F30387
2.030	1.905	0.250	0.062	51.6	48.4	6.4		B	F20164
2.030	1.844	0.250	0.093	51.6	46.8	6.4		S	F20024
2.030	1.780	0.250	0.125	51.6	45.2	6.4		S	F20025
2.030	1.844	0.250	0.093	51.6	46.8	6.4		B	F30026
2.125	1.875	0.375	0.125	54.0	47.6	9.5		B	F20026
2.125	1.875	0.750	0.125	54.0	47.6	19.1		B	F30029
2.125	2.000	1.000	0.062	54.0	50.8	25.4	X	S	F10207
2.187	1.937	1.000	0.125	55.5	49.2	25.4		B	F30187
2.205	1.969	0.197	0.118 *	56.0	50.0	5.0		B	F30206
2.205	1.969	1.102	0.118 *	56.0	50.0	28.0		S	F10291
2.242	2.046	0.193	0.098 *	56.9	52.0	4.9		S	F20029
2.242	2.046	0.193	0.098 *	56.9	52.0	4.9		B	F30031
2.250	2.000	0.375	0.125	57.2	50.8	9.5		S	F20031

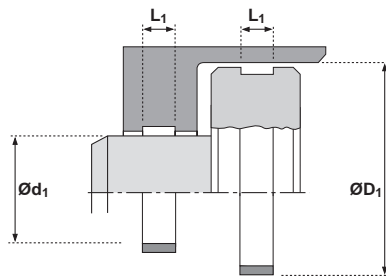

533

ØD ₁ in	ød ₁ in	L ₁ in	S in	ØD ₁ mm	ød ₁ mm	L ₁ mm	Rod Specific	Split Type	PART No
2.250	2.000	0.312	0.125	57.2	50.8	7.9		B	F30032
2.250	2.000	0.375	0.125	57.2	50.8	9.5		B	F30033
2.250	2.000	0.500	0.125	57.2	50.8	12.7		B	F30035
2.250	2.000	0.625	0.125	57.2	50.8	15.9		B	F30036
2.250	2.000	0.750	0.125	57.2	50.8	19.1		B	F30037
2.250	2.000	0.250	0.125	57.2	50.8	6.4		B	F30196
2.250	2.000	1.000	0.125	57.2	50.8	25.4		B	F30371
2.250	2.000	0.375	0.125	57.2	50.8	9.5		B	F40003
2.250	2.000	0.187	0.125	57.2	50.8	4.7		B	F40029
2.358	2.106	0.748	0.126 [†]	59.9	53.5	19.0		B	F30233
2.362	2.112	0.250	0.125	60.0	53.6	6.4		B	F30377
2.375	2.125	0.500	0.125	60.3	54.0	12.7		B	F30038
2.375	2.125	0.750	0.125	60.3	54.0	19.1		B	F30039
2.375	2.250	1.000	0.062	60.3	57.2	25.4	X	S	F10289
2.375	2.250	1.500	0.062	60.3	57.2	38.1	X	S	F10208
2.375	2.250	1.000	0.062	60.3	57.2	25.4	X	S	F10358
2.415	2.165	1.000	0.125	61.3	55.0	25.4		B	F30385
2.441	2.205	1.102	0.118 [†]	62.0	56.0	28.0		S	F10292
2.480	2.235	0.370	0.125	63.0	56.8	9.4		S	F10286
2.480	2.244	0.394	0.118 [†]	63.0	57.0	10.0		B	F30195
2.480	2.181	0.295	0.150 [†]	63.0	55.4	7.5		B	F30214
2.480	2.244	0.197	0.118 [†]	63.0	57.0	5.0		B	F30336
2.500	2.314	0.312	0.093	63.5	58.8	7.9		B	F20039
2.500	2.314	0.312	0.093	63.5	58.8	7.9		B	F30042
2.500	2.250	0.375	0.125	63.5	57.2	9.5		B	F20041
2.500	2.250	0.187	0.125	63.5	57.2	4.7		B	F30040
2.500	2.250	0.250	0.125	63.5	57.2	6.4		B	F30041
2.500	2.250	0.312	0.125	63.5	57.2	7.9		B	F30043

533

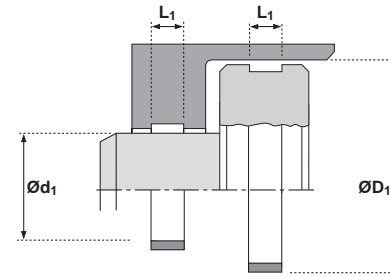

ØD ₁ in	Ød ₁ in	L ₁ in	S in	ØD ₁ mm	Ød ₁ mm	L ₁ mm	Rod Specific	Split Type	PART No
2.500	2.250	0.375	0.125	63.5	57.2	9.5		B	F30044
2.500	2.250	0.500	0.125	63.5	57.2	12.7		B	F30045
2.500	2.250	0.625	0.125	63.5	57.2	15.9		B	F30047
2.500	2.250	0.750	0.125	63.5	57.2	19.1		B	F30048
2.500	2.250	1.000	0.125	63.5	57.2	25.4		B	F30286
2.500	2.250	0.187	0.125	63.5	57.2	4.7		B	F40004
2.500	2.250	0.375	0.125	63.5	57.2	9.5		B	F40005
2.500	2.316	0.375	0.093	63.5	58.8	9.5		B	F30326
2.500	2.375	1.000	0.062	63.5	60.3	25.4	X	S	F10357
2.530	2.405	0.250	0.062	64.3	61.1	6.4		B	F20165
2.530	2.280	0.250	0.125	64.3	57.9	6.4		S	F20044
2.530	2.280	0.250	0.125	64.3	57.9	6.4		B	F30049
2.625	2.500	0.750	0.062	66.7	63.5	19.1	X	S	F10325
2.625	2.375	0.375	0.125	66.7	60.3	9.5		S	F20179
2.625	2.375	0.625	0.125	66.7	60.3	15.9		B	F30285
2.625	2.389	1.186	0.118	66.7	60.7	30.1		B	F30198
2.625	2.500	1.000	0.062	66.7	63.5	25.4	X	S	F10276
2.625	2.500	1.500	0.062	66.7	63.5	38.1	X	S	F10209
2.717	2.471	0.370	0.125	69.0	62.8	9.4		S	F10287
2.717	2.480	1.102	0.118	69.0	63.0	28.0		S	F10293
2.750	2.500	0.375	0.125	69.9	63.5	9.5		B	F20046
2.750	2.500	0.312	0.125	69.9	63.5	7.9		B	F30050
2.750	2.500	0.375	0.125	69.9	63.5	9.5		B	F30051
2.750	2.500	0.500	0.125	69.9	63.5	12.7		B	F30052
2.750	2.500	0.625	0.125	69.9	63.5	15.9		B	F30054
2.750	2.500	0.750	0.125	69.9	63.5	19.1		B	F30055
2.750	2.500	1.000	0.125	69.9	63.5	25.4		B	F30056
2.750	2.500	0.250	0.125	69.9	63.5	6.4		B	F30209

533

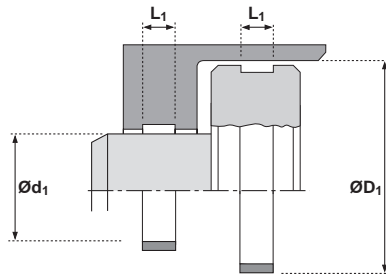

OD_1 in	Ød_1 in	L_1 in	S in	OD_1 mm	Ød_1 mm	L_1 mm	Rod Specific	Split Type	PART No
2.750	2.500	0.250	0.125	69.9	63.5	6.4		B	F40023
2.750	2.500	0.375	0.125	69.9	63.5	9.5		B	F40025
2.756	2.520	0.409	0.118 [†]	70.0	64.0	10.4		B	F30182
2.756	2.520	0.394	0.118 [†]	70.0	64.0	10.0		B	F30190
2.756	2.457	0.295	0.150 [†]	70.0	62.4	7.5		B	F30213
2.756	2.559	0.787	0.098 [†]	70.0	65.0	20.0		B	F30308
2.875	2.625	1.000	0.125	73.0	66.7	25.4		B	F30058
2.875	2.750	1.000	0.062	73.0	69.9	25.4	X	S	F10326
2.875	2.750	1.500	0.062	73.0	69.9	38.1	X	S	F10210
2.929	2.677	0.394	0.126 [†]	74.4	68.0	10.0		B	F30243
2.929	2.677	0.984	0.126 [†]	74.4	68.0	25.0		B	F30244
3.000	2.750	0.312	0.125	76.2	69.9	7.9		S	F20056
3.000	2.750	0.250	0.125	76.2	69.9	6.4		B	F30241
3.000	2.750	0.500	0.125	76.2	69.9	12.7		S	F20058
3.000	2.750	0.375	0.125	76.2	69.9	9.5		B	F30059
3.000	2.750	0.500	0.125	76.2	69.9	12.7		B	F30383
3.000	2.762	0.250	0.119 [†]	76.2	70.2	6.4		B	F20175
3.000	2.808	0.212	0.096 [†]	76.2	71.3	5.4		B	F30060
3.000	2.750	0.375	0.125	76.2	69.9	9.5		B	F20057
3.000	2.750	0.250	0.125	76.2	69.9	6.4		B	F30061
3.000	2.750	0.312	0.125	76.2	69.9	7.9		B	F30062
3.000	2.750	0.375	0.125	76.2	69.9	9.5		B	F30063
3.000	2.750	0.500	0.125	76.2	69.9	12.7		B	F30064
3.000	2.750	0.750	0.125	76.2	69.9	19.1		B	F30066
3.000	2.750	1.000	0.125	76.2	69.9	25.4		B	F30067
3.000	2.750	0.625	0.125	76.2	69.9	15.9		B	F30191
3.000	2.750	0.160	0.125	76.2	69.9	4.1		B	F30379
3.000	2.750	0.375	0.125	76.2	69.9	9.5		B	F40006

533

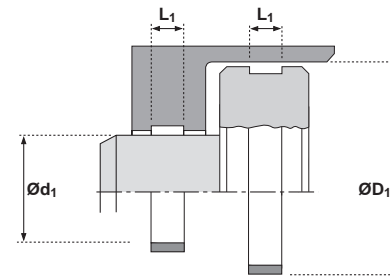

ØD ₁ in	Ød ₁ in	L ₁ in	S in	ØD ₁ mm	Ød ₁ mm	L ₁ mm	Rod Specific	Split Type	PART No
3.000	2.750	0.250	0.125	76.2	69.9	6.4		B	F40007
3.000	2.816	0.375	0.093	76.2	71.5	9.5		B	F30327
3.125	3.000	1.500	0.062	79.4	76.2	38.1	X	S	F10211
3.150	2.913	0.394	0.118 [†]	80.0	74.0	10.0		B	F30170
3.150	2.913	0.409	0.118 [†]	80.0	74.0	10.4		B	F30183
3.150	2.772	0.295	0.190 [†]	80.0	70.4	7.5		B	F30215
3.150	2.900	0.500	0.125	80.0	73.7	12.7		B	F30386
3.220	2.970	0.625	0.125	81.8	75.4	15.9		S	F20157
3.250	3.058	0.212	0.096 [†]	82.6	77.7	5.4		B	F30068
3.250	3.000	0.375	0.125	82.6	76.2	9.5		B	F20062
3.250	3.000	0.375	0.125	82.6	76.2	9.5		B	F30069
3.250	3.000	0.500	0.125	82.6	76.2	12.7		B	F30070
3.250	3.000	0.750	0.125	82.6	76.2	19.1		B	F30072
3.250	3.000	1.000	0.125	82.6	76.2	25.4		B	F30074
3.250	3.000	0.250	0.125	82.6	76.2	6.4		B	F30207
3.250	3.000	0.312	0.125	82.6	76.2	7.9		B	F30259
3.250	3.000	0.625	0.125	82.6	76.2	15.9		B	F30287
3.250	3.000	0.375	0.125	82.6	76.2	9.5		B	F40008
3.250	3.000	1.000	0.125	82.6	76.2	25.4		B	F40009
3.250	3.000	0.250	0.125	82.6	76.2	6.4		B	F40026
3.250	2.876	0.500	0.187 [†]	82.6	73.1	12.7		B	F30263
3.250	3.066	0.375	0.093	82.6	77.9	9.5		B	F30353
3.278	3.028	0.625	0.125	83.3	76.9	15.9		B	F30075
3.280	3.154	0.250	0.062	83.3	80.1	6.4		B	F20166
3.280	3.030	0.250	0.125	83.3	77.0	6.4		S	F20067
3.312	3.126	0.625	0.093	84.1	79.4	15.9		B	F30200
3.339	3.090	0.973	0.125	84.8	78.5	24.7		B	F30343
3.375	3.125	0.750	0.125	85.7	79.4	19.1		B	F30193

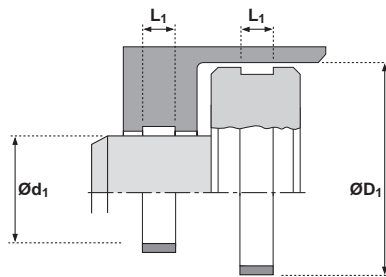

533

ØD ₁ in	Ød ₁ in	L ₁ in	S in	ØD ₁ mm	Ød ₁ mm	L ₁ mm	Rod Specific	Split Type	PART No
3.437	3.187	1.000	0.125	87.3	80.9	25.4		B	F30077
3.500	3.126	0.500	0.187 [†]	88.9	79.4	12.7		B	F20176
3.500	3.126	1.000	0.187 [†]	88.9	79.4	25.4		B	F20177
3.500	3.310	0.212	0.095 [†]	88.9	84.1	5.4		B	F30078
3.500	3.310	0.500	0.095 [†]	88.9	84.1	12.7		B	F30082
3.500	3.314	0.750	0.093	88.9	84.2	19.1		B	F30086
3.500	3.250	0.375	0.125	88.9	82.6	9.5		B	F20071
3.500	3.250	0.250	0.125	88.9	82.6	6.4		B	F30079
3.500	3.250	0.375	0.125	88.9	82.6	9.5		B	F30080
3.500	3.250	0.437	0.125	88.9	82.6	11.1		B	F30081
3.500	3.250	0.500	0.125	88.9	82.6	12.7		B	F30083
3.500	3.250	0.625	0.125	88.9	82.6	15.9		B	F30085
3.500	3.250	0.750	0.125	88.9	82.6	19.1		B	F30087
3.500	3.250	0.312	0.125	88.9	82.6	7.9		B	F30255
3.500	3.250	1.000	0.125	88.9	82.6	25.4		B	F30275
3.500	3.250	0.160	0.125	88.9	82.6	4.1		B	F30380
3.500	3.250	0.250	0.125	88.9	82.6	6.4		B	F40010
3.500	3.250	0.375	0.125	88.9	82.6	9.5		B	F40011
3.500	3.250	0.500	0.125	88.9	82.6	12.7		B	F40012
3.500	3.316	0.375	0.093	88.9	84.2	9.5		B	F30328
3.543	3.293	0.500	0.125	90.0	83.6	12.7		B	F30384
3.543	3.307	0.591	0.118 [†]	90.0	84.0	15.0		B	F30171
3.543	3.307	0.606	0.118 [†]	90.0	84.0	15.4		B	F30184
3.543	3.165	0.295	0.190 [†]	90.0	80.4	7.5		B	F30216
3.543	3.244	0.295	0.150 [†]	90.0	82.4	7.5		B	F30225
3.543	3.307	0.965	0.118 [†]	90.0	84.0	24.5		B	F30293
3.543	3.307	0.984	0.118 [†]	90.0	84.0	25.0		B	F30294
3.605	3.413	0.212	0.096 [†]	91.6	86.7	5.4		B	F30088

533

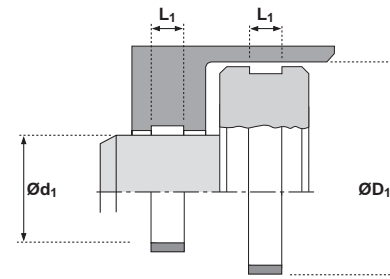

ØD ₁ in	Ød ₁ in	L ₁ in	S in	ØD ₁ mm	Ød ₁ mm	L ₁ mm	Rod Specific	Split Type	PART No
3.605	3.355	0.625	0.125	91.6	85.2	15.9		B	F30089
3.625	3.375	0.500	0.125	92.1	85.7	12.7		B	F30090
3.625	3.375	1.000	0.125	92.1	85.7	25.4		B	F30091
3.750	3.500	0.375	0.125	95.3	88.9	9.5		S	F20082
3.750	3.500	1.500	0.125	95.3	88.9	38.1		S	F20178
3.750	3.500	0.500	0.125	95.3	88.9	12.7		B	F20142
3.750	3.500	0.375	0.125	95.3	88.9	9.5		B	F30092
3.750	3.500	0.500	0.125	95.3	88.9	12.7		B	F30093
3.750	3.500	0.625	0.125	95.3	88.9	15.9		B	F30094
3.750	3.500	0.750	0.125	95.3	88.9	19.1		B	F30095
3.750	3.500	1.000	0.125	95.3	88.9	25.4		B	F30096
3.750	3.500	0.312	0.125	95.3	88.9	7.9		B	F30260
3.750	3.500	1.500	0.125	95.3	88.9	38.1		B	F30283
3.750	3.500	0.375	0.125	95.3	88.9	9.5		B	F40013
3.750	3.500	0.250	0.125	95.3	88.9	6.4		B	F40027
3.937	3.687	1.000	0.125	100.0	93.6	25.4		B	F30097
3.937	3.701	0.591	0.118 [*]	100.0	94.0	15.0		B	F30172
3.937	3.701	0.602	0.118 [*]	100.0	94.0	15.3		B	F30185
3.937	3.701	0.315	0.118 [*]	100.0	94.0	8.0		B	F30245
3.937	3.701	0.984	0.118 [*]	100.0	94.0	25.0		B	F30295
3.939	3.749	0.212	0.095 [*]	100.1	95.2	5.4		B	F30098
3.939	3.689	0.625	0.125	100.1	93.7	15.9		B	F30099
4.000	3.750	0.500	0.125	101.6	95.3	12.7		S	F20091
4.000	3.750	0.375	0.125	101.6	95.3	9.5		B	F20090
4.000	3.750	0.250	0.125	101.6	95.3	6.4		B	F30100
4.000	3.750	0.375	0.125	101.6	95.3	9.5		B	F30101
4.000	3.750	0.500	0.125	101.6	95.3	12.7		B	F30102
4.000	3.750	0.625	0.125	101.6	95.3	15.9		B	F30104

533

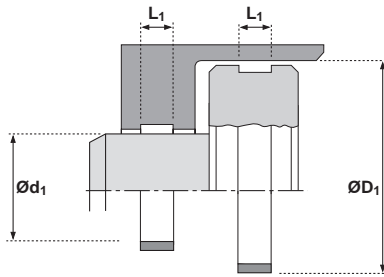

ØD ₁ in	Ød ₁ in	L ₁ in	S in	ØD ₁ mm	Ød ₁ mm	L ₁ mm	Rod Specific	Split Type	PART No
4.000	3.750	0.750	0.125	101.6	95.3	19.1		B	F30105
4.000	3.750	1.000	0.125	101.6	95.3	25.4		B	F30219
4.000	3.750	0.312	0.125	101.6	95.3	7.9		B	F30256
4.000	3.750	0.187	0.125	101.6	95.3	4.7		B	F30344
4.000	3.750	0.160	0.125	101.6	95.3	4.1		B	F30381
4.000	3.750	0.375	0.125	101.6	95.3	9.5		B	F40014
4.000	3.750	0.250	0.125	101.6	95.3	6.4		B	F40028
4.000	3.750	0.625	0.125	101.6	95.3	15.9		B	F40030
4.000	3.626	0.875	0.187 [†]	101.6	92.1	22.2		B	F30212
4.000	3.626	0.500	0.187 [†]	101.6	92.1	12.7		B	F30217
4.000	3.626	1.000	0.187 [†]	101.6	92.1	25.4		B	F30218
4.030	3.906	0.250	0.062	102.4	99.2	6.4		B	F20167
4.030	3.780	0.250	0.125	102.4	96.0	6.4		S	F20094
4.125	3.875	0.375	0.125	104.8	98.4	9.5		B	F20184
4.134	3.883	0.622	0.125	105.0	98.6	15.8		B	F30210
4.134	3.898	0.965	0.118 [†]	105.0	99.0	24.5		B	F30296
4.134	3.937	0.787	0.098 [†]	105.0	100.0	20.0		B	F30389
4.250	4.000	0.500	0.125	108.0	101.6	12.7		S	F20096
4.250	4.000	0.750	0.125	108.0	101.6	19.1		S	F20098
4.250	4.000	1.500	0.125	108.0	101.6	38.1		S	F20174
4.250	4.000	1.500	0.125	108.0	101.6	38.1		B	F10347
4.250	4.000	0.375	0.125	108.0	101.6	9.5		B	F20095
4.250	4.000	0.375	0.125	108.0	101.6	9.5		B	F30107
4.250	4.000	0.500	0.125	108.0	101.6	12.7		B	F30108
4.250	4.000	0.625	0.125	108.0	101.6	15.9		B	F30109
4.250	4.000	0.750	0.125	108.0	101.6	19.1		B	F30110
4.250	4.000	1.000	0.125	108.0	101.6	25.4		B	F30112
4.250	4.000	0.312	0.125	108.0	101.6	7.9		B	F30261

533

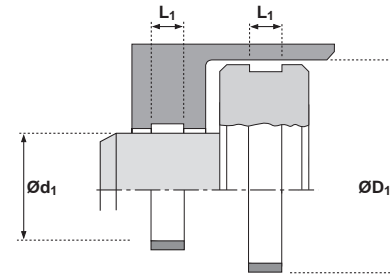

ØD ₁ in	Ød ₁ in	L ₁ in	S in	ØD ₁ mm	Ød ₁ mm	L ₁ mm	Rod Specific	Split Type	PART No
4.250	4.000	1.500	0.125	108.0	101.6	38.1		B	F30270
4.250	4.000	0.250	0.125	108.0	101.6	6.4		B	F30339
4.250	4.000	2.000	0.125	108.0	101.6	50.8		B	F30348
4.250	4.000	0.375	0.125	108.0	101.6	9.5		B	F40015
4.250	4.000	1.000	0.125	108.0	101.6	25.4		B	F40016
4.331	4.094	0.591	0.118 [*]	110.0	104.0	15.0		B	F30173
4.331	4.094	0.984	0.118 [*]	110.0	104.0	25.0		B	F30297
4.331	4.134	0.311	0.098 [*]	110.0	105.0	7.9		B	F30312
4.331	4.094	0.315	0.118 [*]	110.0	104.0	8.0		B	F30349
4.400	4.150	0.625	0.125	111.8	105.4	15.9		B	F30113
4.500	4.250	0.500	0.125	114.3	108.0	12.7		B	F30131
4.500	4.250	0.500	0.125	114.3	108.0	12.7		B	F20102
4.500	4.250	0.750	0.125	114.3	108.0	19.1		B	F20104
4.500	4.250	0.375	0.125	114.3	108.0	9.5		B	F20183
4.500	4.250	0.375	0.125	114.3	108.0	9.5		B	F30114
4.500	4.250	0.500	0.125	114.3	108.0	12.7		B	F30115
4.500	4.250	0.625	0.125	114.3	108.0	15.9		B	F30118
4.500	4.250	0.750	0.125	114.3	108.0	19.1		B	F30120
4.500	4.250	0.312	0.125	114.3	108.0	7.9		B	F30262
4.500	4.250	1.000	0.125	114.3	108.0	25.4		B	F30278
4.528	4.291	0.602	0.118 [*]	115.0	109.0	15.3		B	F30186
4.528	4.291	0.591	0.118 [*]	115.0	109.0	15.0		B	F30192
4.528	4.331	0.311	0.098 [*]	115.0	110.0	7.9		B	F30311
4.528	4.331	0.374	0.098 [*]	115.0	110.0	9.5		B	F30313
4.528	4.291	0.315	0.118 [*]	115.0	109.0	8.0		B	F30347
4.724	4.528	0.311	0.098 [*]	120.0	115.0	7.9		B	F30310
4.724	4.488	0.823	0.118 [*]	120.0	114.0	20.9		B	F30332
4.724	4.488	0.394	0.118 [*]	120.0	114.0	10.0		B	F30358

533

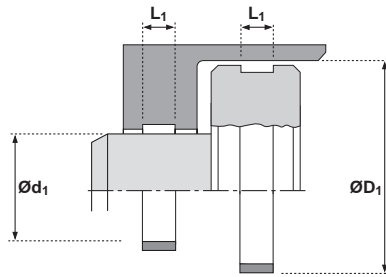

OD_1 in	ød_1 in	L_1 in	S in	OD_1 mm	ød_1 mm	L_1 mm	Rod Specific	Split Type	PART No
4.750	4.500	0.500	0.125	120.7	114.3	12.7		S	F2010 5
4.750	4.490	0.500	0.13 [*]	120.7	114.0	12.7		B	F30122
4.750	4.500	0.500	0.125	120.7	114.3	12.7		B	F30121
4.750	4.500	0.750	0.125	120.7	114.3	19.1		B	F30123
4.750	4.500	1.000	0.125	120.7	114.3	25.4		B	F30124
4.750	4.500	0.375	0.125	120.7	114.3	9.5		B	F30194
4.750	4.500	1.500	0.125	120.7	114.3	38.1		B	F30335
4.750	4.500	0.312	0.125	120.7	114.3	7.9		B	F3036 8
4.750	4.500	0.375	0.125	120.7	114.3	9.5		B	F40021
4.879	4.629	0.750	0.125	123.9	117.6	19.1		B	F30125
4.921	4.798	0.591	0.062	125.0	121.9	15.0		S	F20180
4.921	4.685	0.787	0.118 [*]	125.0	119.0	20.0		B	F301 74
4.921	4.724	0.311	0.098 [*]	125.0	120.0	7.9		B	F30309
4.921	4.685	0.394	0.118 [*]	125.0	119.0	10.0		B	F30350
5.000	4.750	0.500	0.125	127.0	120.7	12.7		S	F20111
5.000	4.750	1.000	0.125	127.0	120.7	25.4		S	F20159
5.000	4.750	0.940	0.125	127.0	120.7	23.9		B	F30290
5.000	4.750	0.625	0.125	127.0	120.7	15.9		B	F20112
5.000	4.750	0.750	0.125	127.0	120.7	19.1		B	F20113
5.000	4.750	0.375	0.125	127.0	120.7	9.5		B	F30126
5.000	4.750	0.500	0.125	127.0	120.7	12.7		B	F30127
5.000	4.750	0.625	0.125	127.0	120.7	15.9		B	F30128
5.000	4.750	0.750	0.125	127.0	120.7	19.1		B	F30129
5.000	4.750	1.000	0.125	127.0	120.7	25.4		B	F30169
5.000	4.750	1.500	0.125	127.0	120.7	38.1		B	F30264
5.000	4.750	0.312	0.125	127.0	120.7	7.9		B	F3036 9
5.000	4.750	0.375	0.125	127.0	120.7	9.5		B	F40020
5.030	4.906	0.375	0.062	127.8	124.6	9.5		B	F20168

533

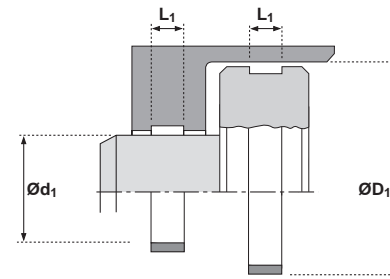

ØD ₁ in	Ød ₁ in	L ₁ in	S in	ØD ₁ mm	Ød ₁ mm	L ₁ mm	Rod Specific	Split Type	PART No
5.030	4.780	0.375	0.125	127.8	121.4	9.5		S	F20114
5.118	4.921	0.311	0.098 [*]	130.0	125.0	7.9		B	F30316
5.118	4.843	1.181	0.138 [*]	130.0	123.0	30.0		B	F30323
5.125	4.875	0.625	0.125	130.2	123.8	15.9		S	F20153
5.125	4.875	0.625	0.125	130.2	123.8	15.9		B	F30205
5.250	5.000	0.625	0.125	133.4	127.0	15.9		S	F20116
5.250	5.000	0.750	0.125	133.4	127.0	19.1		S	F20117
5.250	5.000	0.500	0.125	133.4	127.0	12.7		B	F30131
5.250	5.000	0.625	0.125	133.4	127.0	15.9		B	F30132
5.250	5.000	0.750	0.125	133.4	127.0	19.1		B	F30133
5.250	5.000	1.500	0.125	133.4	127.0	38.1		B	F30265
5.250	5.000	1.000	0.125	133.4	127.0	25.4		B	F30269
5.315	5.118	0.311	0.098 [*]	135.0	130.0	7.9		B	F30315
5.315	5.039	0.583	0.138 [*]	135.0	128.0	14.8		B	F30319
5.500	5.250	0.375	0.125	139.7	133.4	9.5		S	F20118
5.500	5.250	0.500	0.125	139.7	133.4	12.7		S	F20119
5.500	5.250	0.625	0.125	139.7	133.4	15.9		S	F20120
5.500	5.250	1.500	0.125	139.7	133.4	38.1		S	F20173
5.500	5.250	0.750	0.125	139.7	133.4	19.1		B	F20162
5.500	5.250	0.375	0.125	139.7	133.4	9.5		B	F30135
5.500	5.250	0.500	0.125	139.7	133.4	12.7		B	F30136
5.500	5.250	0.625	0.125	139.7	133.4	15.9		B	F30138
5.500	5.250	0.750	0.125	139.7	133.4	19.1		B	F30140
5.500	5.250	1.000	0.125	139.7	133.4	25.4		B	F30141
5.500	5.250	1.500	0.125	139.7	133.4	38.1		B	F30266
5.500	5.250	0.312	0.125	139.7	133.4	7.9		B	F30370
5.512	5.276	0.591	0.118 [*]	140.0	134.0	15.0		B	F30175
5.512	5.276	0.591	0.118 [*]	140.0	134.0	15.0		B	F30175

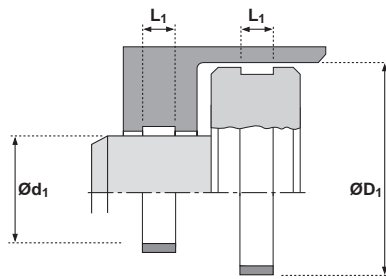

533

ØD ₁ in	ød ₁ in	L ₁ in	S in	ØD ₁ mm	ød ₁ mm	L ₁ mm	Rod Specific	Split Type	PART No
5.512	5.276	0.787	0.118 [†]	140.0	134.0	20.0		B	F30202
5.512	5.236	1.378	0.138 [†]	140.0	133.0	35.0		B	F30298
5.512	5.315	0.311	0.098 [†]	140.0	135.0	7.9		B	F30314
5.512	5.276	0.394	0.118 [†]	140.0	134.0	10.0		B	F30351
5.709	5.433	0.583	0.138 [†]	145.0	138.0	14.8		B	F30318
5.750	5.500	0.750	0.125	146.1	139.7	19.1		B	F30143
5.750	5.500	1.000	0.125	146.1	139.7	25.4		B	F30144
5.750	5.500	1.500	0.125	146.1	139.7	38.1		B	F30267
5.875	5.625	0.750	0.125	149.2	142.9	19.1		B	F30388
5.906	5.630	1.378	0.138 [†]	150.0	143.0	35.0		B	F30299
5.906	5.630	0.583	0.138 [†]	150.0	143.0	14.8		B	F30317
6.000	5.876	0.375	0.062	152.4	149.3	9.5		B	F20169
6.000	5.750	1.500	0.125	152.4	146.1	38.1		S	F20170
6.000	5.750	0.625	0.125	152.4	146.1	15.9		B	F20126
6.000	5.750	0.500	0.125	152.4	146.1	12.7		B	F30145
6.000	5.750	0.625	0.125	152.4	146.1	15.9		B	F30147
6.000	5.750	1.000	0.125	152.4	146.1	25.4		B	F30149
6.000	5.750	0.750	0.125	152.4	146.1	19.1		B	F30208
6.000	5.750	1.500	0.125	152.4	146.1	38.1		B	F30268
6.000	5.750	0.375	0.125	152.4	146.1	9.5		B	F30150
6.030	5.780	0.375	0.125	153.2	146.8	9.5		S	F20128
6.250	6.000	0.625	0.125	158.8	152.4	15.9		B	F30151
6.250	6.000	1.000	0.125	158.8	152.4	25.4		B	F30153
6.250	6.000	1.500	0.125	158.8	152.4	38.1		B	F30274
6.250	6.000	0.500	0.125	158.8	152.4	12.7		B	F30279
6.299	6.176	0.591	0.062	160.0	156.9	15.0		S	F20181
6.299	6.063	0.591	0.118 [†]	160.0	154.0	15.0		B	F30176
6.299	6.063	0.787	0.118 [†]	160.0	154.0	20.0		B	F30203

533

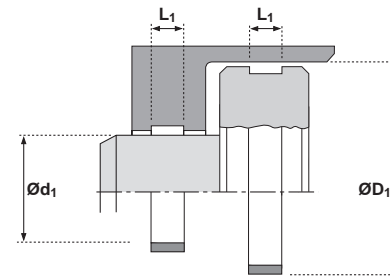

ØD ₁ in	Ød ₁ in	L ₁ in	S in	ØD ₁ mm	Ød ₁ mm	L ₁ mm	Rod Specific	Split Type	PART No
6.299	6.024	1.575	0.138 [†]	160.0	153.0	40.0		B	F30300
6.500	6.250	1.500	0.125	165.1	158.8	38.1		S	F20172
6.500	6.250	0.500	0.125	165.1	158.8	12.7		B	F30154
6.500	6.250	1.000	0.125	165.1	158.8	25.4		B	F30157
6.500	6.250	0.750	0.125	165.1	158.8	19.1		B	F30199
6.500	6.250	1.500	0.125	165.1	158.8	38.1		B	F30273
6.750	6.500	1.500	0.125	171.5	165.1	38.1		B	F30272
6.750	6.500	1.000	0.125	171.5	165.1	25.4		B	F30276
6.875	6.625	1.000	0.125	174.6	168.3	25.4	X	B	F30393
6.890	6.575	1.181	0.158 [†]	175.0	167.0	30.0		B	F30390
7.000	6.750	1.500	0.125	177.8	171.5	38.1		S	F20171
7.000	6.750	0.500	0.125	177.8	171.5	12.7		B	F30158
7.000	6.750	0.625	0.125	177.8	171.5	15.9		B	F30159
7.000	6.750	1.000	0.125	177.8	171.5	25.4		B	F30160
7.000	6.750	1.500	0.125	177.8	171.5	38.1		B	F30271
7.000	6.750	0.750	0.125	177.8	171.5	19.1		B	F30277
7.087	6.850	0.787	0.118 [†]	180.0	174.0	20.0		B	F30204
7.087	6.772	1.772	0.158 [†]	180.0	172.0	45.0		B	F30320
7.250	7.000	0.500	0.125	184.2	177.8	12.7		B	F30281
7.250	7.000	0.750	0.125	184.2	177.8	19.1		B	F30284
7.250	7.000	1.000	0.125	184.2	177.8	25.4		B	F30289
7.480	7.165	1.772	0.158 [†]	190.0	182.0	45.0		B	F30301
7.500	7.250	0.750	0.125	190.5	184.2	19.1		S	F20158
7.500	7.250	0.500	0.125	190.5	184.2	12.7		B	F30162
7.500	7.250	0.750	0.125	190.5	184.2	19.1		B	F30165
7.500	7.250	1.000	0.125	190.5	184.2	25.4		B	F30166
7.750	7.500	0.500	0.125	196.9	190.5	12.7		S	F20160
7.750	7.500	1.000	0.125	196.9	190.5	25.4		B	F30247

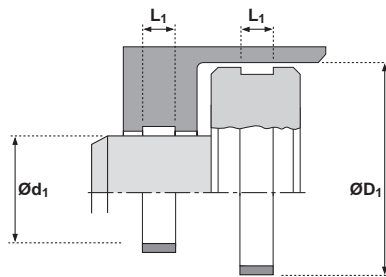

533

$\text{Ø}D_1$ in	$\text{Ø}d_1$ in	L_1 in	S in	$\text{Ø}D_1$ mm	$\text{Ø}d_1$ mm	L_1 mm	Rod Specific	Split Type	PART No
7.874	7.750	0.787	0.062	200.0	196.9	20.0		S	F20182
7.874	7.559	0.866	0.158 [†]	200.0	192.0	22.0		B	F30321
7.874	7.559	1.772	0.158 [†]	200.0	192.0	45.0		B	F30322
7.874	7.638	0.787	0.118 [†]	200.0	194.0	20.0		B	F30324
8.000	7.750	0.500	0.125	203.2	196.9	12.7		B	F30167
8.000	7.750	1.000	0.125	203.2	196.9	25.4		B	F30231
8.030	7.780	0.500	0.125	204.0	197.6	12.7		S	F20140
8.030	7.780	0.500	0.125	204.0	197.6	12.7		B	F40024
8.250	8.000	1.000	0.125	209.6	203.2	25.4		B	F30248
8.500	8.250	0.500	0.125	215.9	209.6	12.7		S	F20141
8.500	8.250	0.500	0.125	215.9	209.6	12.7		B	F30168
8.500	8.250	1.000	0.125	215.9	209.6	25.4		B	F30246
8.750	8.500	1.000	0.125	222.3	215.9	25.4		B	F30249
8.819	8.504	1.772	0.158 [†]	224.0	216.0	45.0		B	F30302
9.000	8.750	1.000	0.125	228.6	222.3	25.4		B	F30230
9.125	8.875	1.000	0.125	231.8	225.4	25.4		B	F30288
9.250	9.000	1.000	0.125	235.0	228.6	25.4		B	F30253
9.500	9.250	1.000	0.125	241.3	235.0	25.4		B	F30254
9.555	9.305	1.000	0.125	242.7	236.3	25.4		S	F20161
9.750	9.500	1.000	0.125	247.7	241.3	25.4		B	F30250
10.000	9.750	1.000	0.125	254.0	247.7	25.4		B	F30221
10.093	9.843	1.000	0.125	256.4	250.0	25.4		B	F30373
10.250	10.000	1.000	0.125	260.4	254.0	25.4		B	F30258
10.500	10.250	1.000	0.125	266.7	260.4	25.4		B	F30257
10.625	10.375	1.000	0.125	269.9	263.5	25.4		B	F30374
11.000	10.750	1.000	0.125	279.4	273.1	25.4		B	F30222
11.250	11.000	1.000	0.125	285.8	279.4	25.4		B	F30251
11.500	11.250	1.000	0.125	292.1	285.8	25.4		B	F30252

533

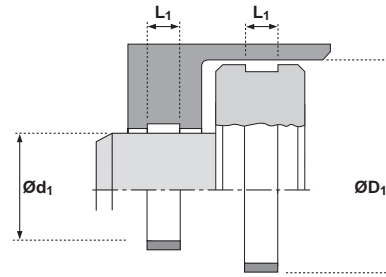

ØD ₁ in	Ød ₁ in	L ₁ in	S in	ØD ₁ mm	Ød ₁ mm	L ₁ mm	Rod Specific	Split Type	PART No
12.000	11.750	1.000	0.125	304.8	298.5	25.4		B	F30223
12.750	12.500	1.000	0.125	323.9	317.5	25.4		B	F30376
13.000	12.750	1.000	0.125	330.2	323.9	25.4		B	F30224

* For housing details please contact Hallite Seals